

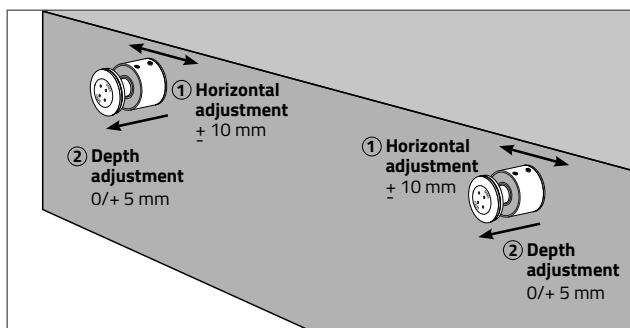

SLAB NOSE RAILING - Height 40 mm Ref. **00 01 10**

BEFORE LAYING THE GLASS



AFTER LAYING THE GLASS

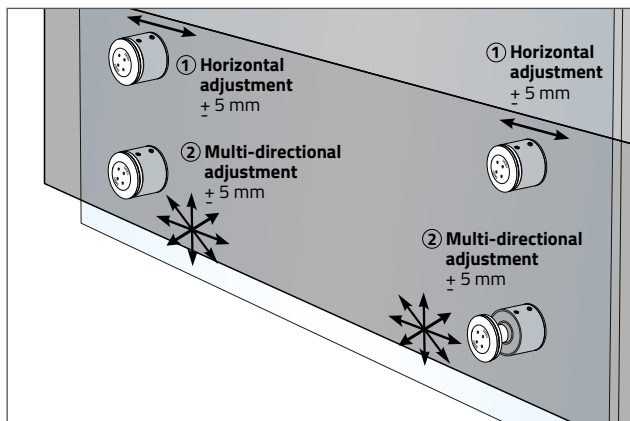

TECHNICAL DATA

SPECIFICITY	Dual glass adjustment system
Diameter	50 mm
Height	40 mm
Weight	465 gr
Material	Stainless steel 304 & 316
Tightening the glass screw	Hardened monolithic = Mini 15 N.m Hardened laminated = 10 N.m
Type of glass	Laminated glass - tempered type 8 /8, 10/10, 12/12 or 15/15 according to configuration
Screws	Socket head screw $\varnothing 12$. Dowel to be defined according to nature of the slab or support. Excluding SADEV supply.
Screws for glass	Cylindrical $\varnothing 50$
Glass dimension approved	Height 1 260 mm Lenght 1 000 to 1400 mm
Glass thickness	17,52 21,52 25,52 31,52

CERTIFICATIONS

Technical Advice with AGC n° 2/15-1670

Test report N° BEB1.9.4027-9

Test report N° BEB1.9.4027-15

Test report N° BEB1.9.4027-16

WALL POINT FIXINGS





SLAB NOSING RAILING - Height 30 mm

Ref. **00 01 30**

TECHNICAL DATA

SPECIFICITY Without adjustment

Diameter	50mm	
Height	30mm	
Reference	Material	Glass thickness
00 01 30	Stainless steel 304	17,52 > 21.52 mm
00 01 30-A4	Stainless steel 316	22 > 25,52 mm

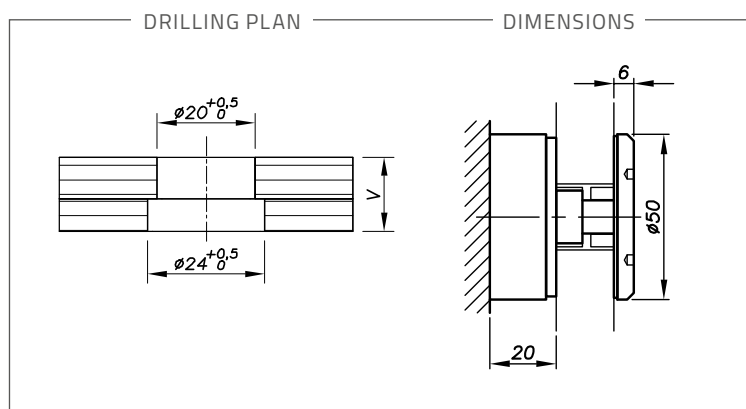

SLAB NOSING RAILING - Height 20 mm

Ref. **00 01 20**



Black finish

TECHNICAL DATA

SPECIFICITY Without adjustment

Diameter	50mm	
Height	20mm	
Reference	Material	Glass thickness
00 01 20	Stainless steel 304	17,52 > 21.52mm
00 01 20-25	Stainless steel 304	22 > 25,52mm
00 01 20N	Stainless steel 304 Black finish	17,52 > 21.52mm
00 01 20-A4	Stainless steel 316	17,52 > 21.52mm

